

# PROFILS ANTI- EXTRUSION

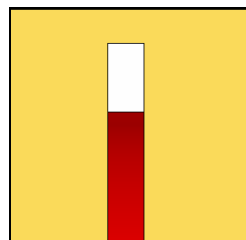

BUR08

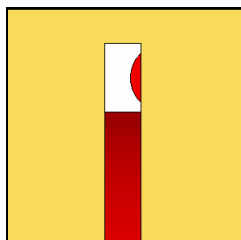

BUR09

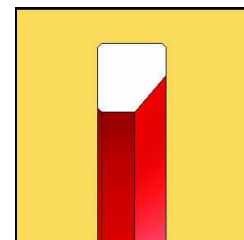

BUR10

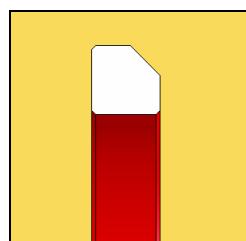

BUR11

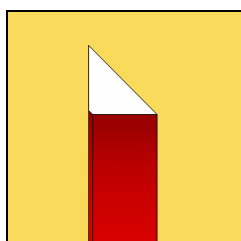

BUR12

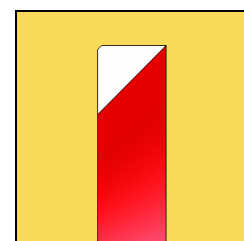

BUR13

Pour voir les familles de profils suivantes descendre le curseur

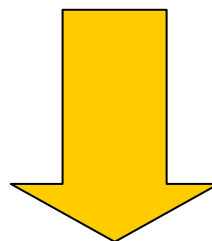

# PROFILS POUR GUIDAGE

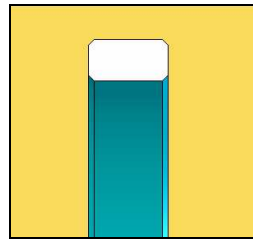

**BWR01**

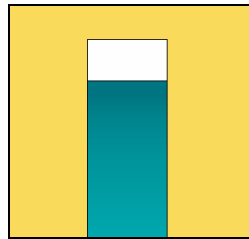

**BWR02**

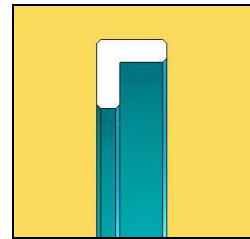

**BWR03**

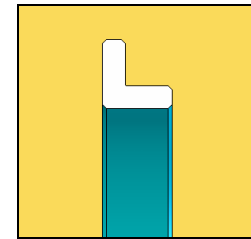

**BWR04**

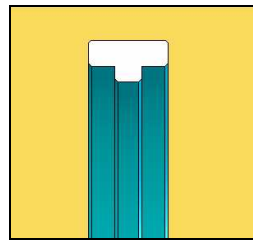

**BWR05**

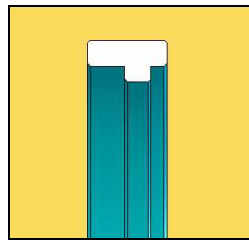

**BWR05A**

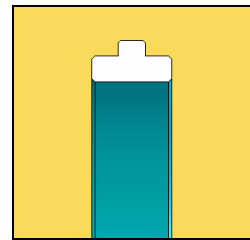

**BWR06**

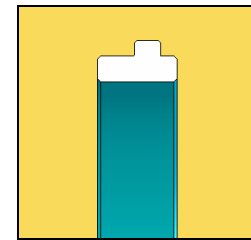

**BWR06A**

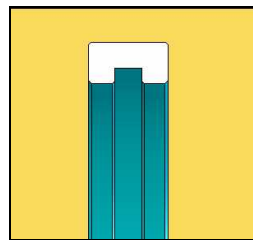

**BWR07**

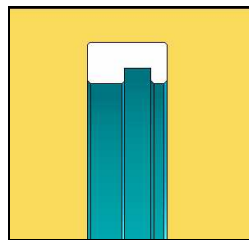

**BWR07A**

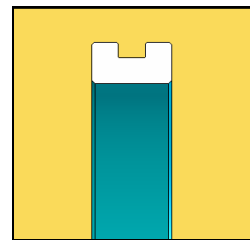

**BWR08**

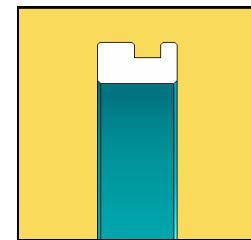

**BWR08A**



# PROFILS POUR ETANCHEITE DE PISTON

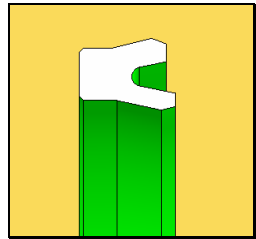

PS01

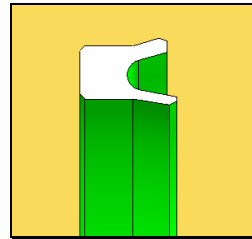

PS01A

Pneumatique

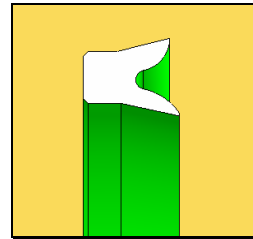

PS01B

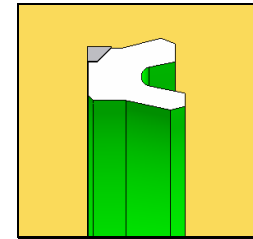

PS02

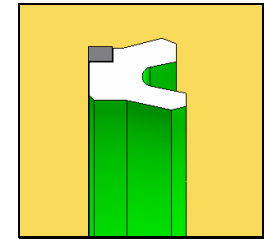

PS02A

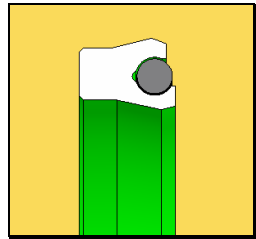

PS03

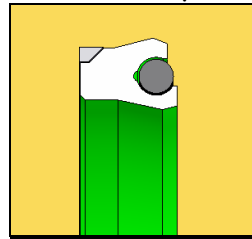

PS04

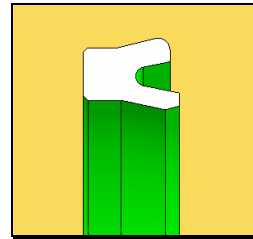

PS05

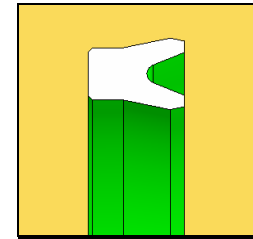

PRS06

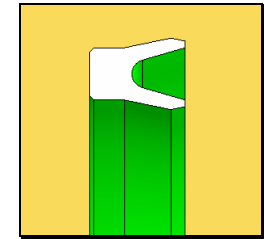

PRS06A

Pneumatique

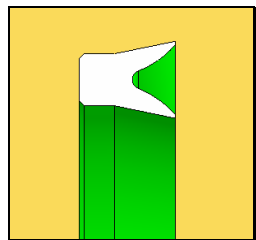

PRS06B

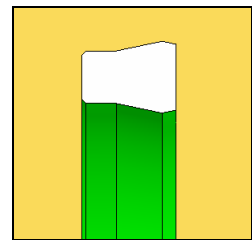

PRS06C

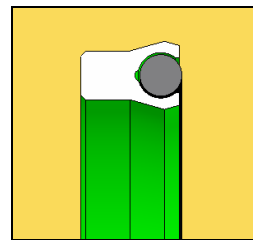

PRS07

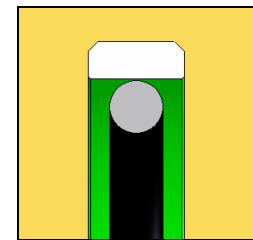

PS08

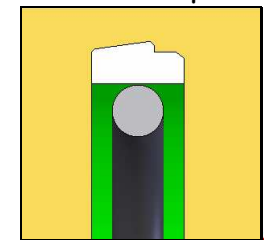

PS08B



# PROFILS POUR ETANCHEITE DE PISTON (suite)

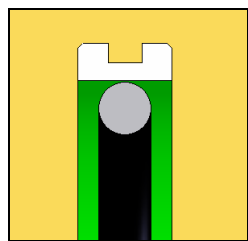

PS08C

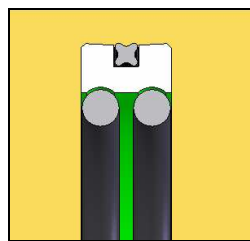

PS08D

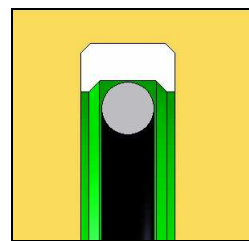

PS08E

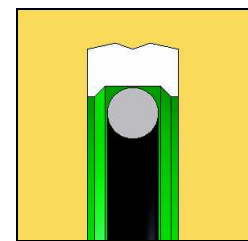

PS08F

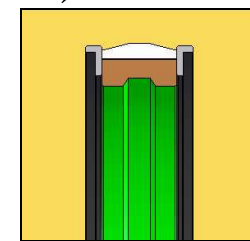

PS09

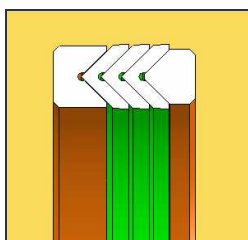

PRS10 PRS11 PRS12

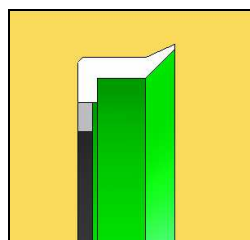

PS16+BUR08

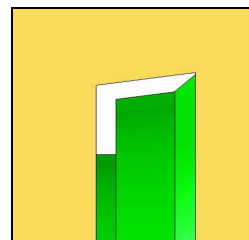

PS16A

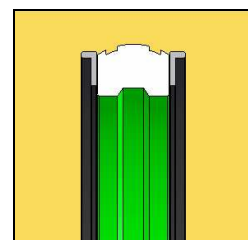

PS17

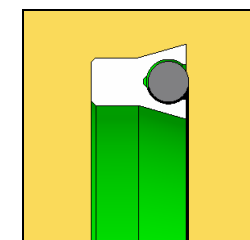

PRS18

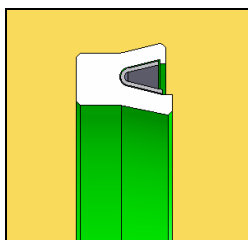

PS19

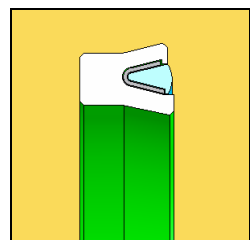

PS19/S

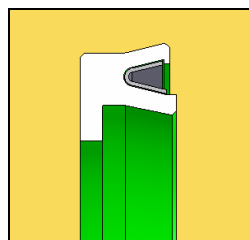

PS19A

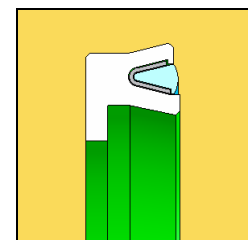

PS19A/S

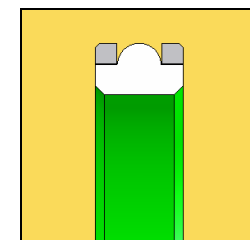

PS20

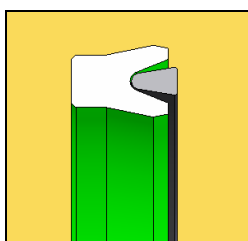

PRS22

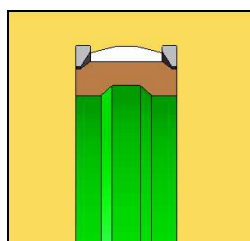

PS23

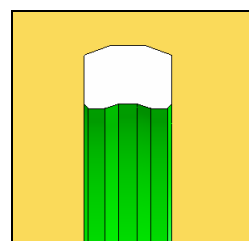

PS35

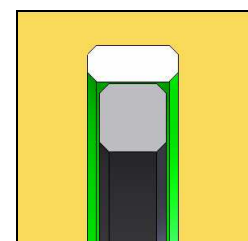

PS81

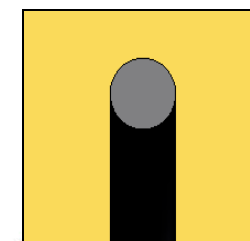

R013



# PROFILS POUR ETANCHEITE DE TIGE

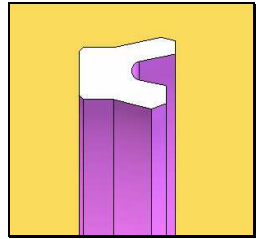

RS01

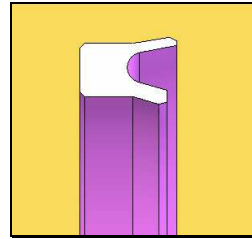

RS01A

Pneumatique

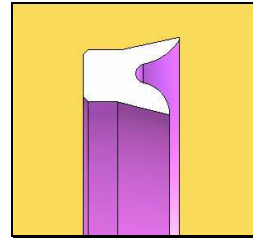

RS01B

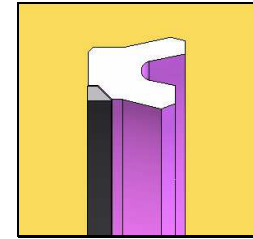

RS02

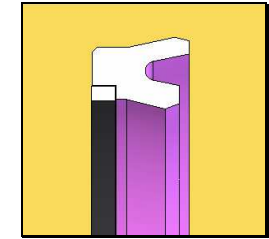

RS02A

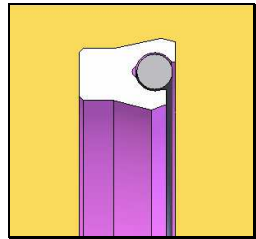

RS03

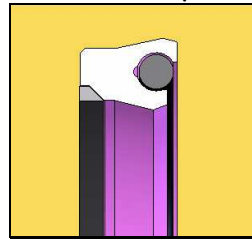

RS04

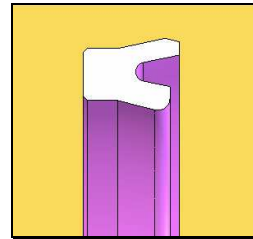

RS05

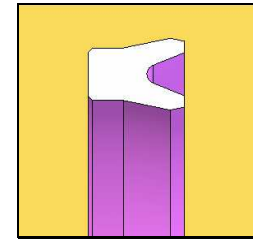

PRS06

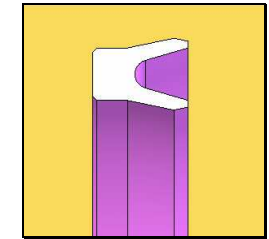

PRS06A

Pneumatique

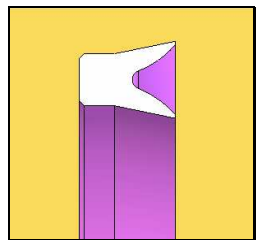

PRS06B

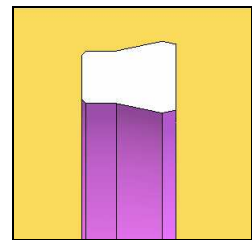

PRS06C

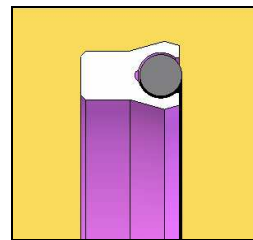

PRS07

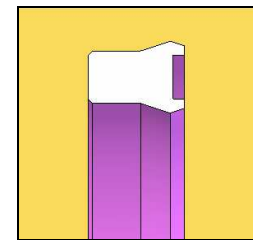

RS08

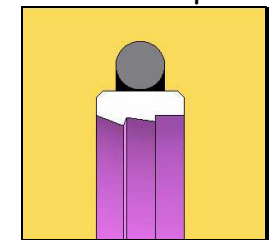

RS09



# PROFILS POUR ETANCHEITE DE TIGE (suite)

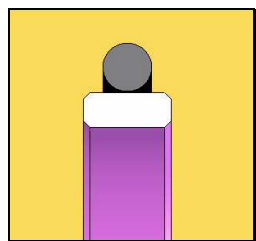

RS09A

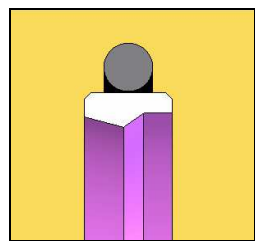

RS09B

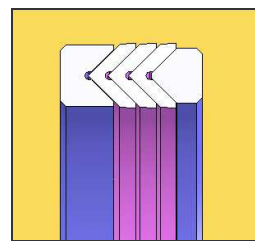

PRS10 PRS11 PRS12

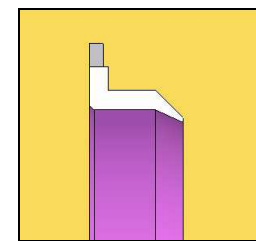

RS16+BUR08

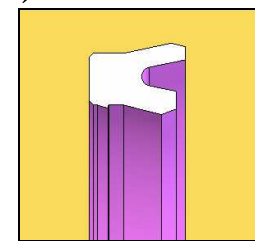

RS17

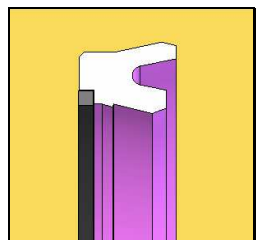

RS17A

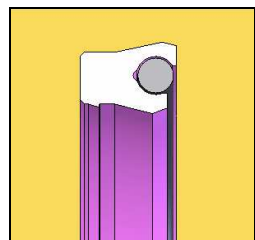

RS17B

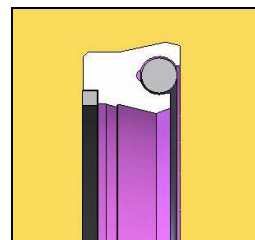

RS17C

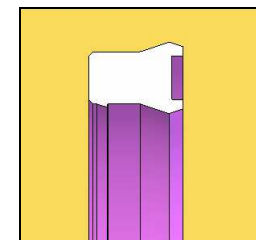

RS17D

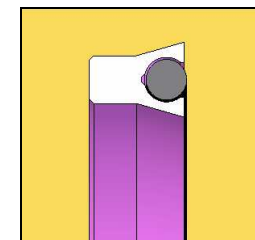

PRS18

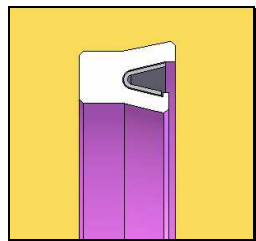

RS19

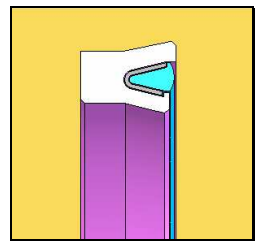

RS19/S

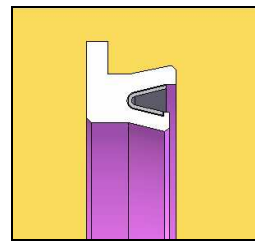

RS19A

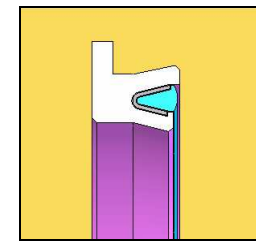

RS19A/S

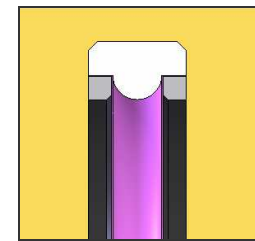

RS20

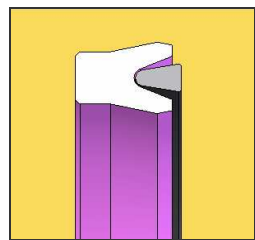

PRS22

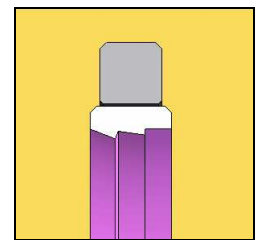

RS91

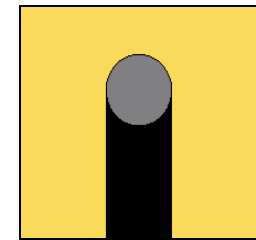

R013



# PROFILS SYMETRIQUES

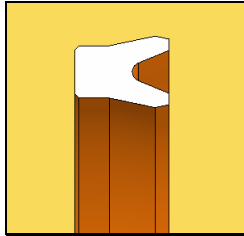

PRS06

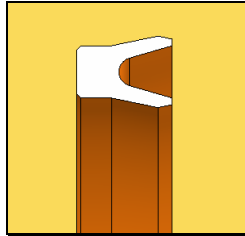

PRS06A

Pneumatique

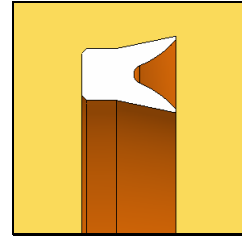

PRS06B

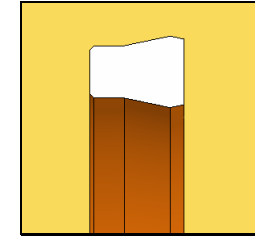

PRS06C

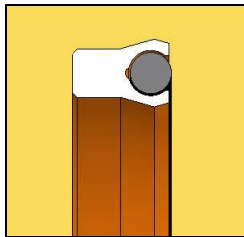

PRS07

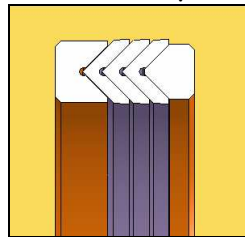

PRS10 PRS11 PRS12

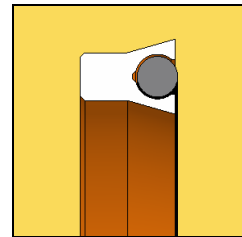

PRS18

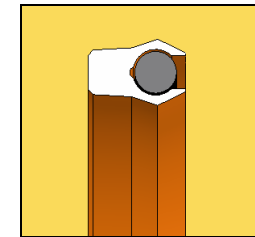

PRS19B

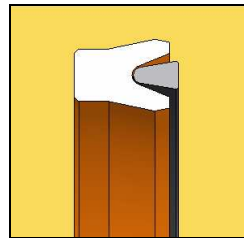

PRS22

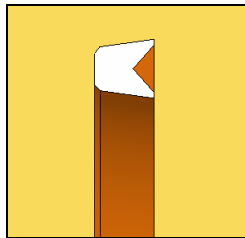

PRS99

UMP

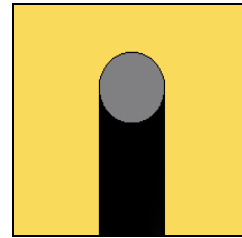

R013



# JOINTS RACLEURS

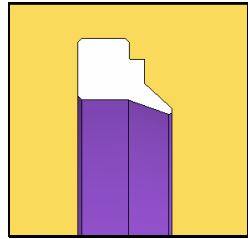

WR01

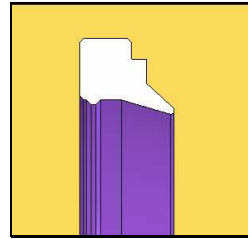

WR01A

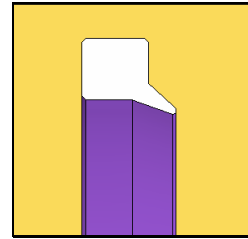

WR02

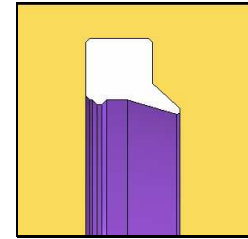

WR02A

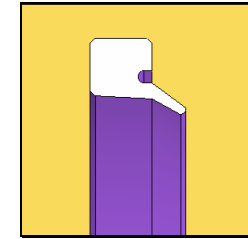

WR02B

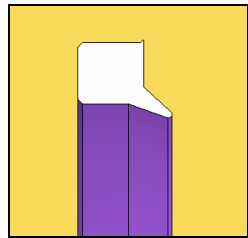

WR02C

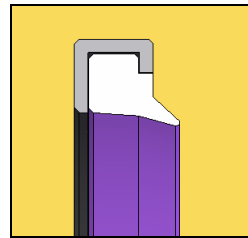

WR03

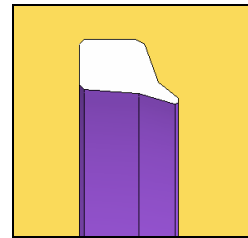

WR04

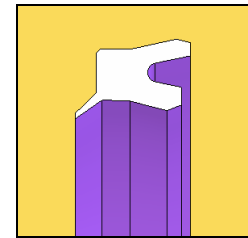

WR11

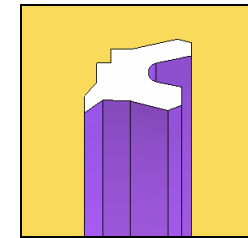

WR12

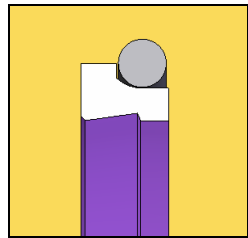

WR13

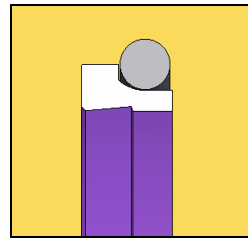

WR13E

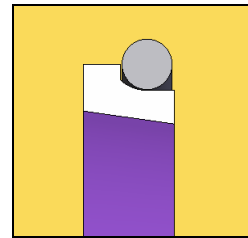

WR14

Plan obligatoire

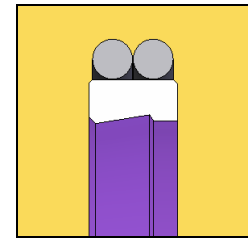

WR15

Plan obligatoire

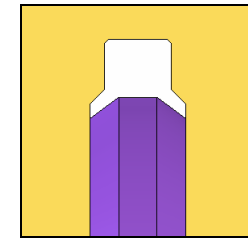

WR17

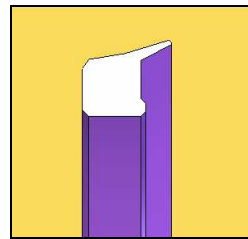

WR18

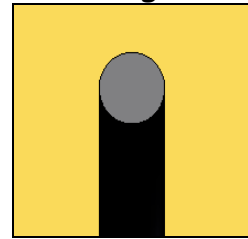

R013





# JOINTS ROTATIFS

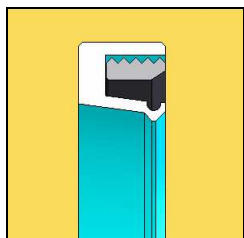

OS01

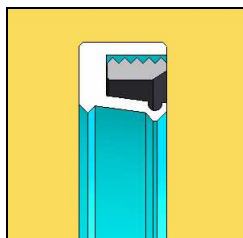

OS02

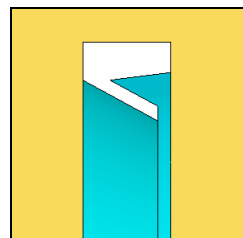

OS08

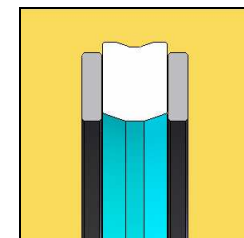

R03

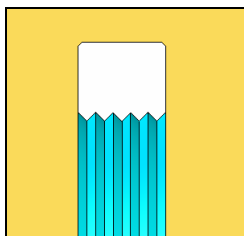

R04

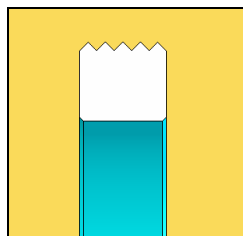

R05

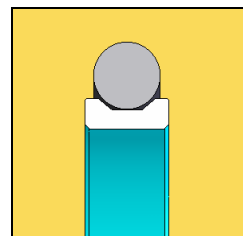

R08

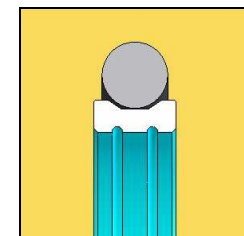

R09

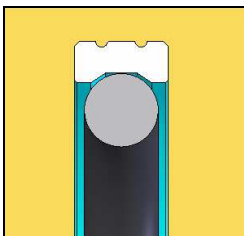

R10

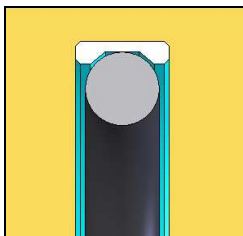

R11

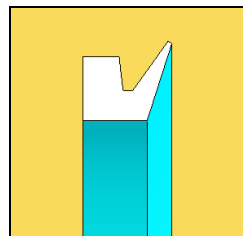

VR06

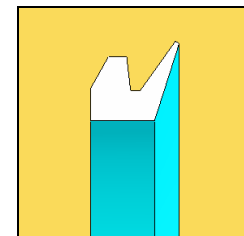

VR07

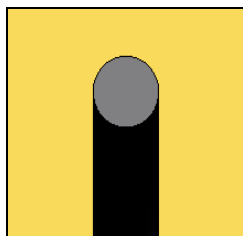

R013

